



**Technical Service
BULLETIN**

May 16, 2003

Title:
**DOOR GLASS WINDOW RUN
IMPROVEMENT**

Models:
'03 Matrix



**BODY
B0013-03**

Introduction Some customers may experience a loose or deformed front or rear door glass window run. Parts have been improved to resolve this condition.

Applicable Vehicles

- **2003** model year **Matrix** vehicles produced before the VIN shown below.

MODEL	STARTING VIN
Matrix	2T1**3#E*3C063222

PREVIOUS PART NUMBER	CURRENT PART NUMBER	PART NAME	QTY
68141-01031	Same	Run, Front Door Glass, RH	1
68142-01030	Same	Run, Rear Door Glass, RH	1
68151-01021	Same	Run, Front Door Glass, LH	1
68152-01020	Same	Run, Rear Door Glass, LH	1

TOOLS & MATERIALS	3M PART NUMBER
3M Super Weatherstrip Adhesive (or equivalent)	051135-08001 051135-08002 051135-08008

OP CODE	DESCRIPTION	TIME	OFF	T1	T2
BD3001	R & R Door Glass Run, Front	0.5	681*1-010*1	62	13
Combo A	Opposite Side	0.4			
BD3002	Reattach Door Glass Run, Front	0.3			
Combo A	Opposite Side	0.2	681*2-010*0	62	57
BD3003	R & R Door Glass Run, Rear	0.5			
Combo A	Opposite Side	0.4			
BD3004	Reattach Door Glass Run, Rear	0.3			
Combo A	Opposite Side	0.2			57

Applicable Warranty*:
This repair is covered under the Toyota Comprehensive Warranty. This warranty is in effect for 36 months or 36,000 miles, whichever occurs first, from the vehicle's in-service date.

* Warranty application is limited to correction of a problem based upon a customer's specific complaint.



**Front Door
Repair
Procedure**

**If the Front Door Glass Run is
Deformed:**

1. Place window in down position.
2. Remove Power Window Regulator Switch Assembly (W/Power Window).

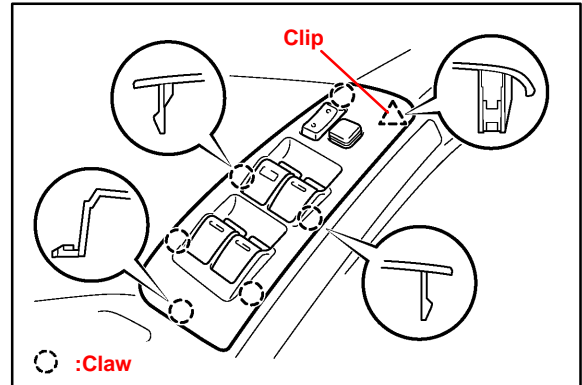

3. Remove Front Door Window Regulator Handle Assembly (W/O Power Window).
 - A. Using a shop rag, remove snap ring.
 - B. Remove the front door window regulator handle and plate.

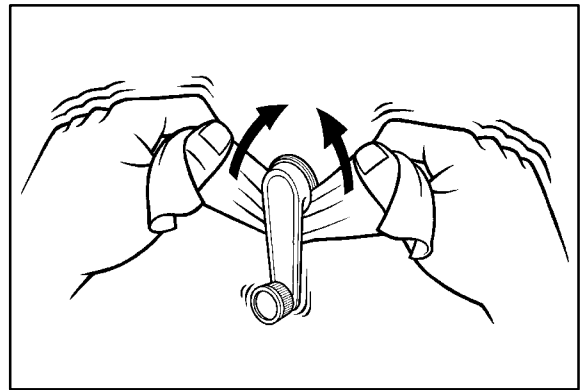

4. Remove Front Door Pull Handle.
5. Lift access cover and remove attaching screw from the Door Inside Handle Sub-Assembly.

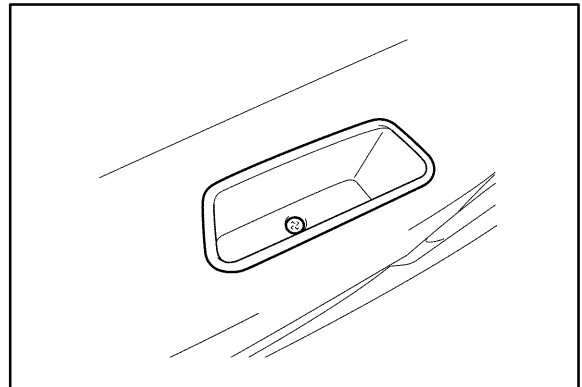

6. Remove Front Door Lower Frame Bracket Garnish.

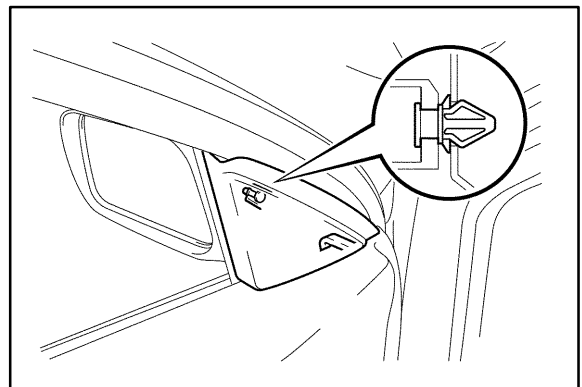

**Front Door
Repair
Procedure**
(Continued)

7. Remove Front Door Trim Board Sub-Assembly (see diagram for clip location).
8. Remove Door Glass Window Run.
9. Install New Door Glass Window Run.
10. Reassemble in reverse order.

NOTE:

Please refer to the 2003 Matrix Repair Manual Vol. 2, pg. 75–5 for additional information.

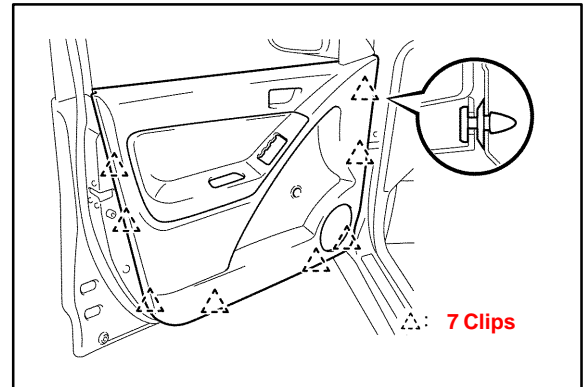

**Rear Door
Repair
Procedure**

If the Rear Door Glass Run is Deformed:

1. Place window in down position.
2. Remove Rear Door Window Regulator Handle Assembly (W/O Power Window).
 - A. Using a shop rag, remove snap ring.
 - B. Remove the rear door window regulator handle and plate.
3. Remove Rear Door Pull Handle.
4. Lift access cover and remove attaching screw from the Door Inside Handle Sub-Assembly.

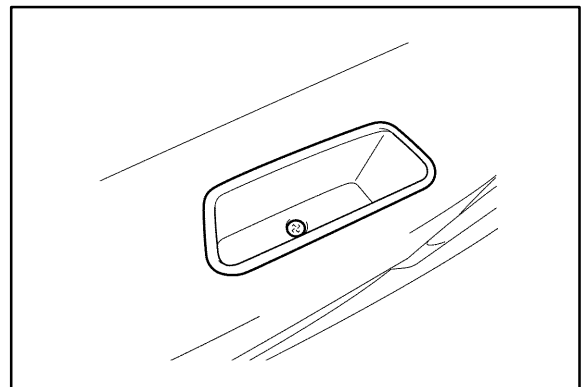
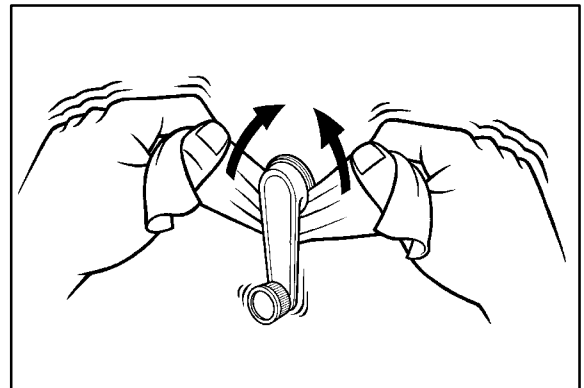

**Rear Door
Repair
Procedure**
(Continued)

5. Remove Rear Door Trim Board Sub-Assembly (see diagram for clip location).
6. Remove Door Glass Window Run.
7. Install New Door Glass Window Run.
8. Reassemble in reverse order.

NOTE:

Please refer to the 2003 Matrix Repair Manual, Vol. 2, pg. 75–18 for additional information.

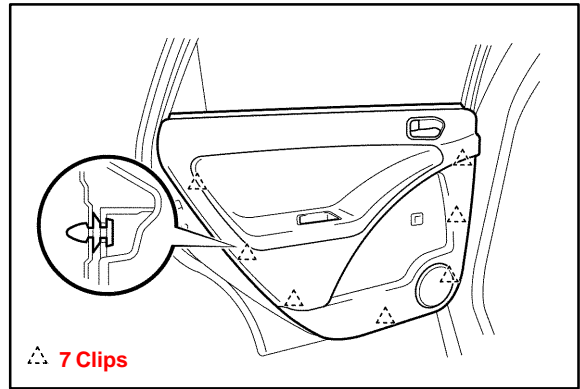
**If the Door Glass Run is loose:**

Carefully reattach it using 3M Super Weatherstrip Adhesive, or equivalent.